



Handrail Supports

General hardware



Legge handrail supports offer the market a strong and simple to use product that is available in two models, a zinc die cast model with exposed fixings or a stainless steel model with both exposed or concealed fixing. Ideal for architectural specification in commercial and residential projects of all sizes.

Features

- Supplied with screws
- Available in zinc die cast or stainless steel
- Two styles available
- Choice of visible or concealed fixings
- The 10 year warranty provides specifiers and users with assured quality

Specification guide

Model	Finish
Zinc die cast support..... DAX1421	Satin chrome plate..... SCP
Stainless steel support..... DAX1431	Satin stainless steel..... SSS

1. Model
Select the desired model e.g. Die cast DAX1421
2. Finish
Select the desired finish e.g. Satin chrome plate DAX1431SCP

Specifications

Material	1421 - Zinc die cast
	1431 - Stainless steel
Finishes	1421 - Satin chrome plate
	1431 - Satin stainless steel
Warranty	10 year mechanical

1421

Visible fix flat top

Finish: Satin chrome plate

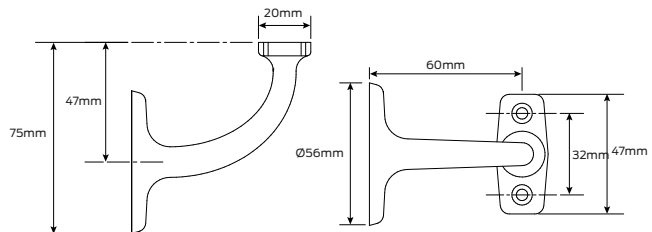
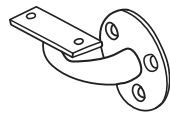

1431

Visible fix flat top

Finish: Satin stainless steel

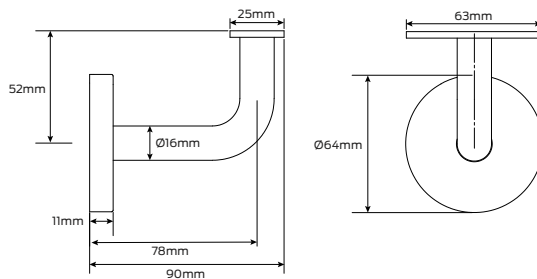
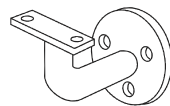

Concealed fix flat top

Finish: Satin stainless steel

